

## Multilayer pipes with fire protection wrap and AF/ArmaFlex insulation in wall and floor seals

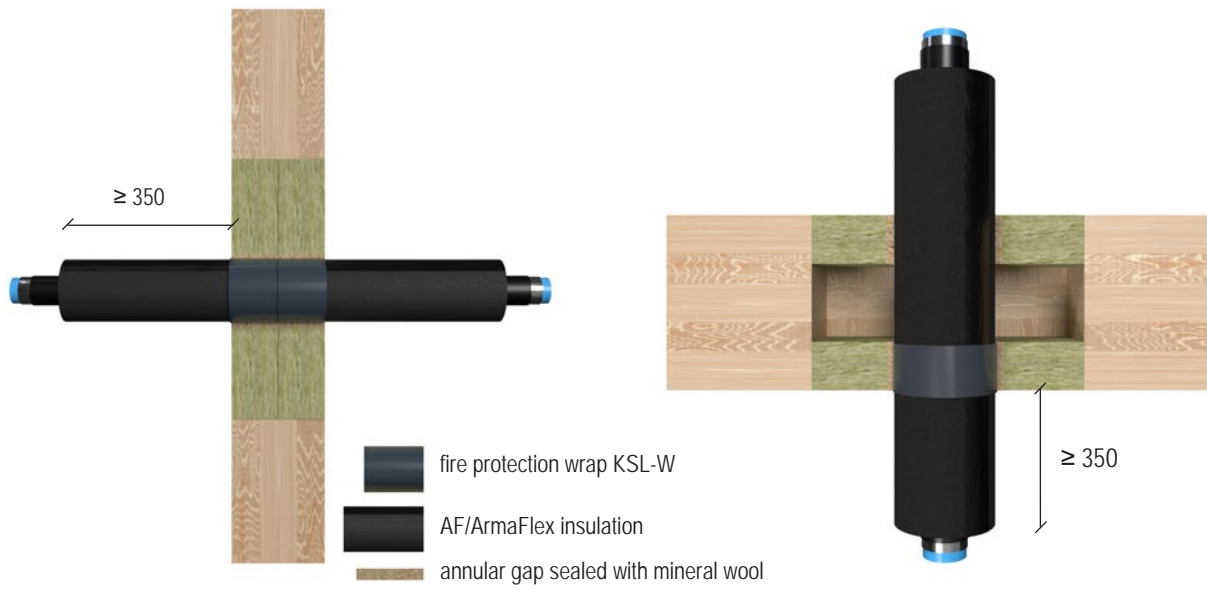

All specifications in mm

The fire protection wrap KSL-W can either be installed flush with the seal surface or protrude up to 5 mm from the seal.

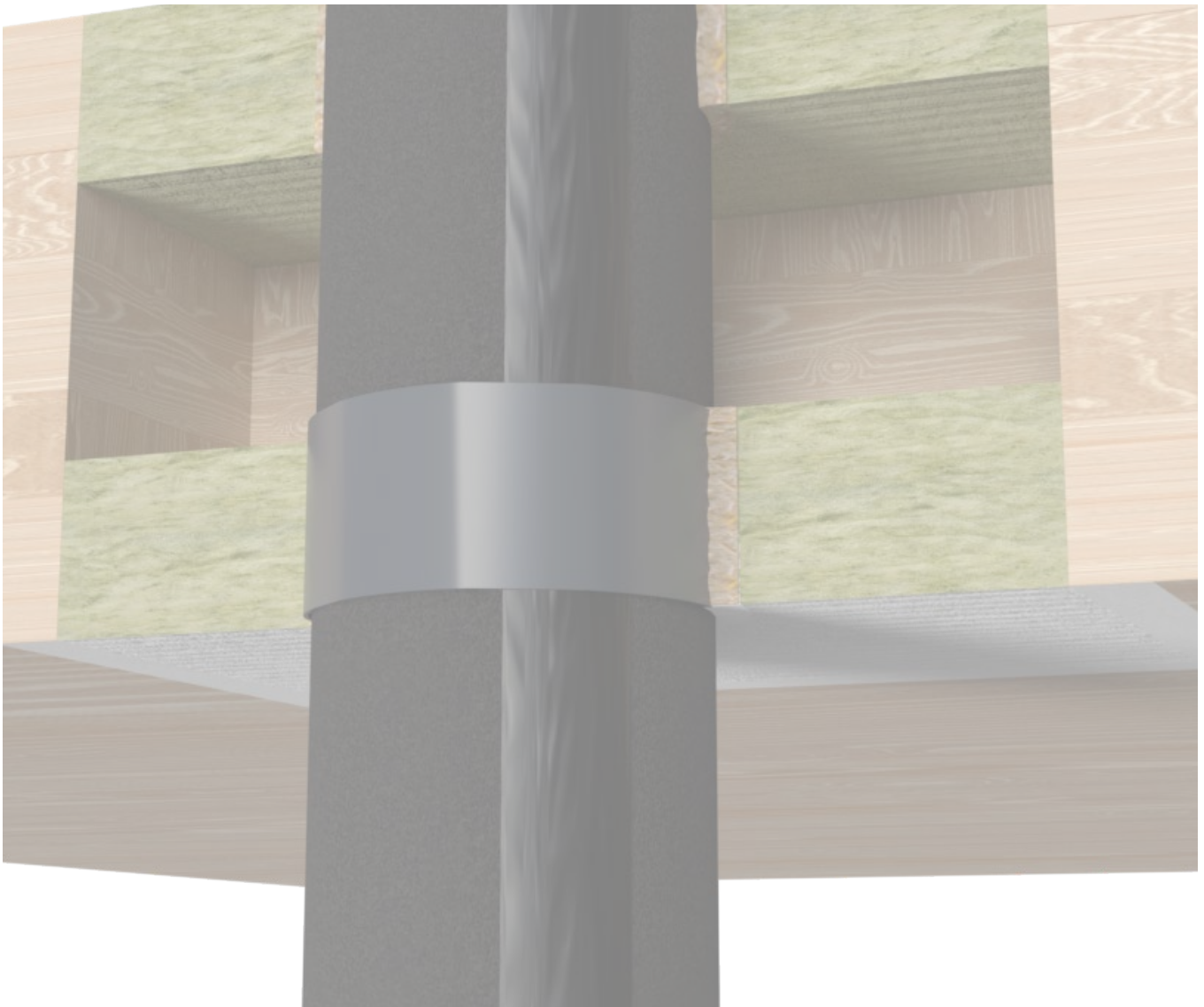

Wall											
Type of pipe	Outer diameter [mm]	Pipe wall thickness [mm]	Type of insulation	Insulation length L [mm]	Insulation thickness [mm]	KSL-W					Fire resistance class
						Wrap width [mm]	Number of wraps [n]	Inside seal [mm]	Outside seal [mm]	Number of layers [n]	
Geberit Mepla	16.0	2.25	AF/ ArmaFlex	≥ 350	8.0–32.0	50	2	50	0	1	EI 90 U/C
	20.0	2.5			9.0–35.0						
	26.0	3.0									
	32.0	3.0			9.0–35.0					2	
	40.0	3.5									
	50.0	4.0			9.0–39.0						
	63.0	4.5			9.5						
	75.0	4.7			9.5–40.5						
	REHAU RAUTITAN stabil	16.0			2.6					AF/ ArmaFlex	
20.0		2.9	8.5–35.0								
25		3.79		9.0–35.0							
32		4.7	9.0–35.0								
40		6.0		9.0–35.0							
KE KELIT KELOX	16.0	2.0	AF/ ArmaFlex	≥ 350	8.0–32.0	50	2	50	0	1	EI 90 U/C
	18.0				8.5–35.0						
	20.0										
	25.0	2.5			9.0–35.0						
	32.0	3.0									
	40.0	4.0			9.0–35.0					2	
	50.0	4.5									
	63.0	6.0			9.0						
	75.0	7.5			9.0–39.0						
					9.5–40.5					EI 90 U/C	

Floor												
Type of pipe	Outer diameter [mm]	Pipe wall thickness [mm]	Type of insulation	Insulation length L [mm]	Insulation thickness [mm]	KSL-W					Fire resistance class	
						Wrap width [mm]	Number of wraps [n]	Inside seal [mm]	Outside seal [mm]	Number of layers [n]		
Geberit Mepla	16.0	2.25	AF/ ArmaFlex	≥ 350.0	8.0–32.0	50	1	50	0	1	EI 90 U/C	
	20.0	2.5			8.0–32.0						EI 90 U/C	
	26.0	3.0			8.5–35.0						EI 90 U/C	
	32.0				9.0–35.0						EI 90 U/C	
	40.0	3.5			9.0–35.0					2	EI 90 U/C	
	50.0	4.0			9.0–35.0						EI 90 U/C	
	63.0	4.5			9.0–39.0						EI 90 U/C	
	75.0	4.7			9.5						EI 90 U/C	
					9.5–40.5					EI 90 U/C		
REHAU RAUTITAN stabil	16.0	2.6	AF/ ArmaFlex	≥ 350.0	8.0–32.0	50	1	50	0	1	EI 90 U/C	
	20.0	2.9									EI 90 U/C	
	25.0	3.79									8.5–35.0	EI 90 U/C
	32.0	4.7									9.0–35.0	EI 90 U/C
	40.0	6.0								2	EI 90 U/C	
KE KELIT KELOX	16.0	2.0	AF/ ArmaFlex	≥ 350.0	8.0–32.0	50	1	50	0		1	EI 90 U/C
	18.0									EI 90 U/C		
	20.0	2.25								EI 90 U/C		
	25.0	2.5								8.5–35.0		EI 90 U/C
	32.0	3.0								2		EI 90 U/C
	40.0	4.0									9.0–35.0	EI 90 U/C
	50.0	4.5									EI 90 U/C	
	63.0	6.0								9.0–39.0	EI 90 U/C	
75.0	7.5	9.5–40.5	EI 90 U/C									