

Cables in wall and floor seals

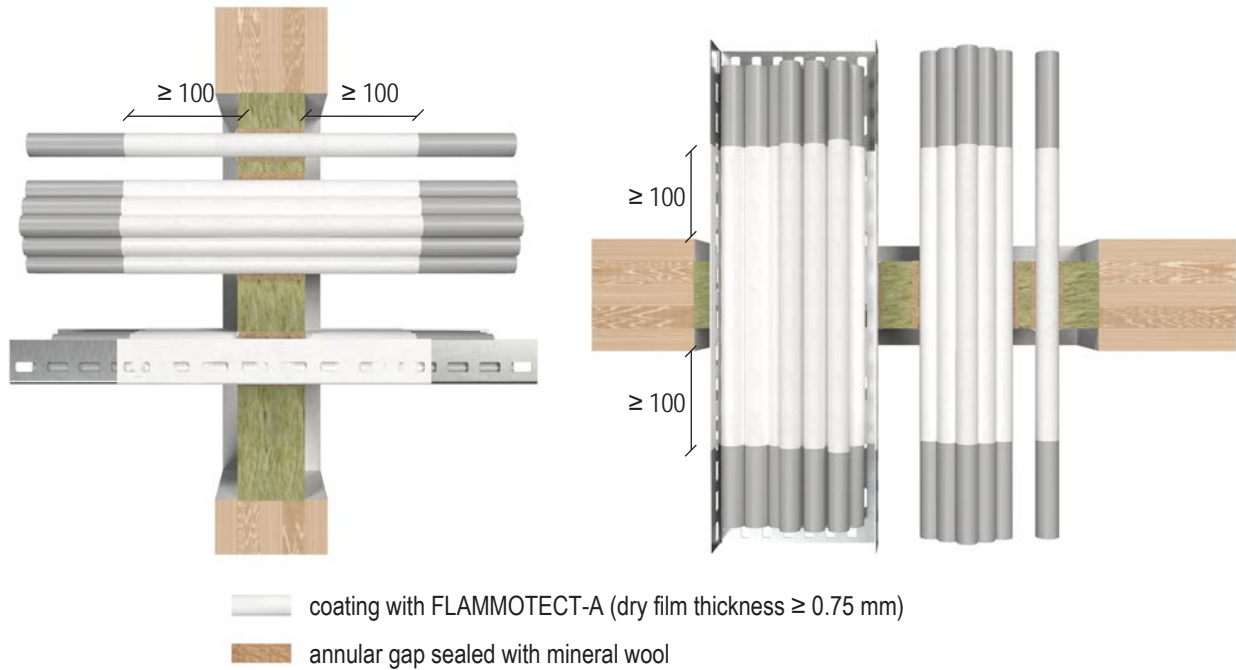

All specifications in mm

Wall		
Services	Coating on both sides with FLAMMOTECT-A	Fire resistance class
Cables $\varnothing \leq 21$ mm	≥ 100 mm \times ≥ 0.75 mm dry film thickness	EI 60
Cables $\varnothing \leq 50$ mm		EI 60
Cables $\varnothing \leq 80$ mm		EI 60
Cable bundles $\varnothing \leq 100$ mm		EI 60
Conduits made of steel $\varnothing \leq 16$ mm		EI 60 U/C
Conduits made of plastic $\varnothing \leq 16$ mm		EI 60 U/U

Floor		
Services	Coating on both sides with FLAMMOTECT-A	Fire resistance class
Cables $\varnothing \leq 21$ mm	≥ 100 mm \times ≥ 0.75 mm dry film thickness	EI 60
Cables $\varnothing \leq 50$ mm		EI 60
Cables $\varnothing \leq 80$ mm		EI 60
Cable bundles $\varnothing \leq 100$ mm		EI 60
Conduits made of steel $\varnothing \leq 16$ mm		EI 60 U/C
Conduits made of plastic $\varnothing \leq 16$ mm		EI 60 U/U

Wave guides and coaxial cables in wall and floor seals

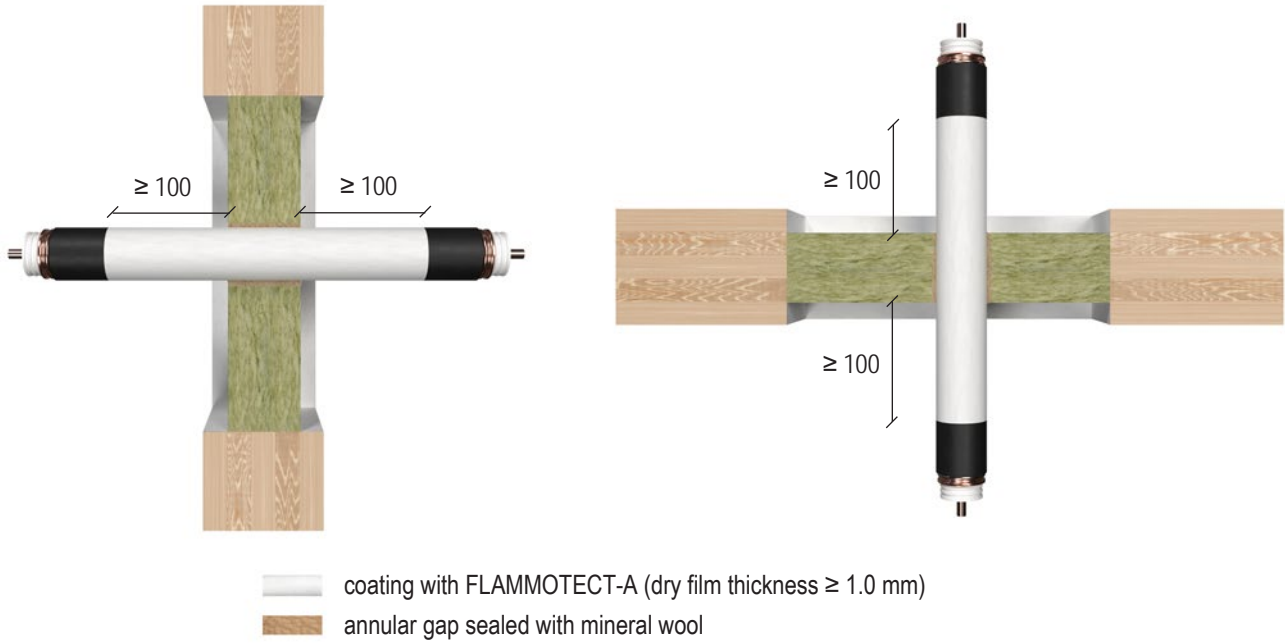

All specifications in mm

Wall		
Services	Coating on both sides with FLAMMOTECT-A	Fire resistance class
CommScope HELIAX®, $\varnothing \leq 51.1$	≥ 100 mm × ≥ 1.0 mm dry film thickness	EI 45 U/C / E 60 U/C
RFS CELLFLEX®, $\varnothing \leq 50.3$		EI 60 U/C
RFS RADIAFLEX®, $\varnothing \leq 48.2$		EI 60 U/C
Floor		
Services	Coating on both sides with FLAMMOTECT-A	Fire resistance class
CommScope HELIAX®, $\varnothing \leq 51.1$	≥ 100 mm × ≥ 1.0 mm dry film thickness	EI 45 U/C / E 60 U/C
RFS CELLFLEX®, $\varnothing \leq 50.3$		EI 45 U/C / E 60 U/C
RFS RADIAFLEX®, $\varnothing \leq 48.2$		EI 60 U/C

