

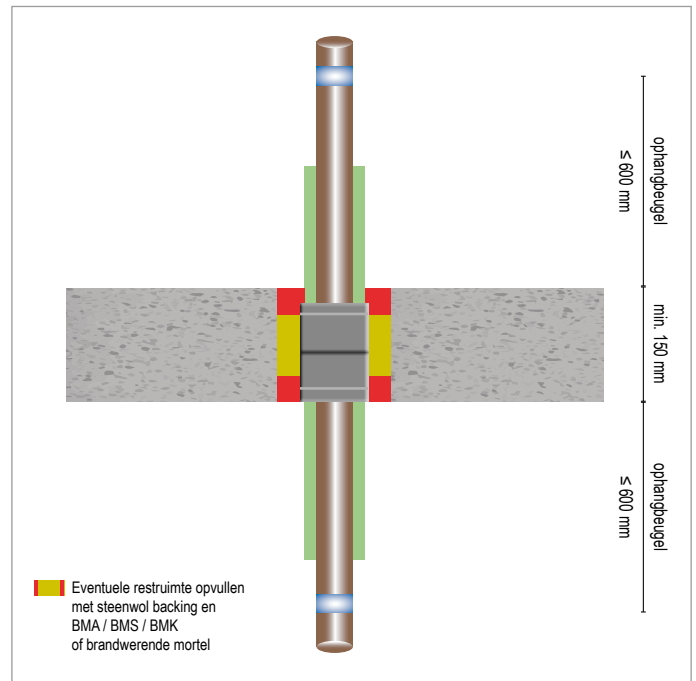

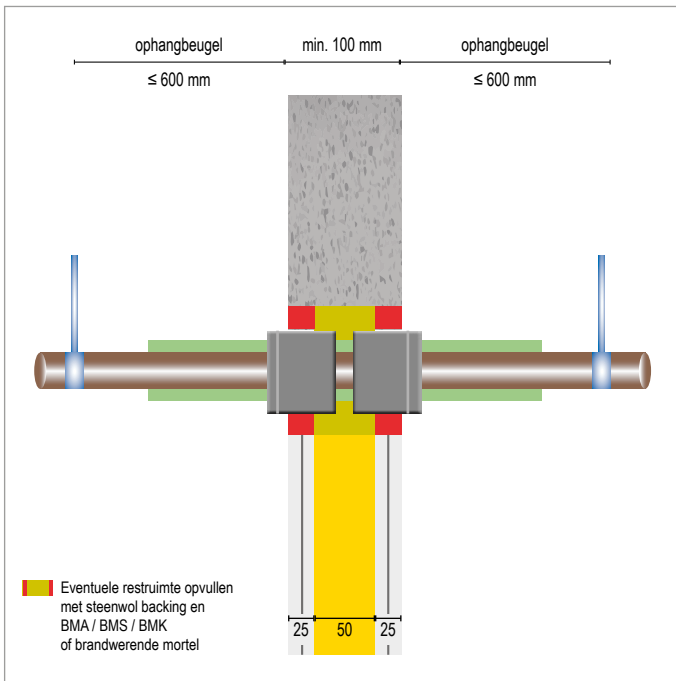





FLAMRO® DG-CR Variant N-III Firewrap

Hardschuim isolatie / Firewrap



KLEINE SPARING < 40 MM

-  Niet-brandbare Metalen leiding
-  Hardschuim isolatie
-  Lichte Scheidingswand
-  Massieve Wand / Massieve Vloer
-  FLAMRO® DG-CR Variant N-III Firewrap

Doorvoer		Diameter (max)	Isolatie	Afdichting	Wikkels	Brandweerstandklasse		Goedkeurings document
						Wand	Vloer	
	Staalbuis	≤ 169	Insulpir / phen 80 mm	FLAMRO® DG-CR Variant N-III Firewrap	4	EI = 60 C/U	-	2001020-FLA
	Staalbuis	≤ 114	Insulpir / phen 30 mm	FLAMRO® DG-CR Variant N-III Firewrap	2	-	EI = 60 C/U	Efectis R00996

Deze handleiding dient als ondersteuning voor een juiste montage.
Voor uitgebreide montagedetails, zie *Installation Manual*

Alle maten in mm

Bij afwijkende situaties raadpleeg onze technische support:

 +31 10 72 71 044

 info@svt-products.nl